

## Overview of Testing Results for Lead in Drinking Water and Corrective Actions for Naval Weapons Station Yorktown Building 2101

The safety and wellness of child development centers, schools, and youth centers is a top priority. To reduce children's potential exposure to lead from facility drinking water, Navy policy requires that we test the lead content of drinking water in these priority areas every five years.

Lead is a toxic metal and exposure can have a wide range of adverse health effects for children in critical developmental stages. Exposure to lead for children may lead to lowered birth weight, slowed physical and mental development, lowered IQ levels, impaired hearing, reduced attention span, and poor classroom performance. Lead in drinking water may come from the existing plumbing inside buildings, including fittings, solder, water coolers, or water faucets. Lead is more likely to be found in drinking water when the water has not been run for an extended period of time and has been sitting in the plumbing system.

Between October 2024 and April 2025, Navy environmental personnel conducted lead testing for drinking water at the Youth Activity Center Building 2101 in accordance with Navy and United States Environmental Protection Agency (EPA) guidelines. Water samples were sent to James R. Reed & Associates, a state-certified laboratory, for analysis.

At Building 2101, water from outlets used for drinking, cooking, and washing was tested. Out of 21 samples, none of the outlets tested higher than the 10 parts per billion (ppb) screening level for lead, which is a level designated by EPA as a threshold for additional action and corrective measures, if necessary.

A summary of all test results is included for your information in the following enclosures:

- **Enclosure 1:** Summary of results
  - **Table 1 Summary of Results** summarizes the data by category of use. The table provides a description of each sampling location using four columns; *Category*, *Outlet No.*, *Sample Identification*, and *Outlet Description*. The *Category* column contains information about whether the outlet is used for drinking water (water fountain), cooking (food preparation), or washing (primarily handwashing). The *Outlet No.* is the inventory number for the outlets at the facility. The *Sample Identification* column is the unique identification used to label each sample bottle. The *Outlet Description* column contains additional information to describe the outlet sampled under each category. The next set of columns in **Table 1** provides *Initial Sampling Results*. EPA sampling protocol requires water to not be used from 8 to 18 hours prior to first draw sampling, to the extent practicable. Therefore, the *Initial Sampling Results* were from first draw samples collected in the early morning.
  - **Table 2 Summary of Statistics** summarizes all data collected at the building during this event.
- **Enclosure 2:** Floor plan of Building 2101 and a summary of the outlets tested.

Table 1. Summary of Results

SAMPLING LOCATION DESCRIPTION				INITIAL SAMPLING RESULTS			RE-SAMPLING RESULTS			CORRECTIVE ACTIONS	POST REMEDIATION SAMPLING RESULTS					
CATEGORY Water Intended For:	SAMPLE IDENTIFICATION	OUTLET NO.	Outlet Description	First Draw (ppb)	Retest required?	Date Fixture Secured?	Recommended Level = 10 parts per billion (ppb)				Description	Recommended Level = 10 ppb				
							Water Fountain 15 min. Follow up Flush Sample - Collected day before First Draw Sampling (ppb)	First Draw (ppb)	Follow up Flush - Collected 30 seconds after First Draw Sampling (ppb)	First Draw (ppb)		Follow up Flush - Collected 30 seconds after First Draw Sampling (ppb)				
				SAMPLING DATE				10/18/2024			N/A	N/A	N/A		N/A	
				RESULTS DATE				10/28/2024			N/A	N/A	N/A		N/A	
DRINKING	YT-2101-HALL-WFCA-FD	11	Hallway water fountain (cooler) A	non-detect	No	N/A	N/A	N/A	N/A	N/A	N/A	N/A				
DRINKING	YT-2101-HALL-WFCB-FD	12	Hallway water fountain (cooler) B	non-detect	No	N/A	N/A	N/A	N/A	N/A	N/A	N/A				
DRINKING	YT-2101-OUTSIDE-WFBA-FD	19	Outside water fountain (bubbler) A	non-detect	No	N/A	N/A	N/A	N/A	N/A	N/A	N/A				
DRINKING	YT-2101-OUTSIDE-WFBB-FD	20	Outside water fountain (bubbler) B	non-detect	No	N/A	N/A	N/A	N/A	N/A	N/A	10/18/2024: Not sampled. Awaiting repairs. 4/3/2025: Outlet sampled				
COOKING	YT-2101-K-K-FD	3	Kitchen sink for dishwashing, food preparation	non-detect	No	N/A	N/A	N/A	N/A	N/A	N/A	N/A				
WASHING	YT-2101-BATHA-HHW-FD	1	Restroom A high hand washing faucet with motion sensor	non-detect	No	N/A	N/A	N/A	N/A	N/A	N/A	N/A				
WASHING	YT-2101-BATHB-HHW-FD	4	Restroom B high hand washing faucet with motion sensor	non-detect	No	N/A	N/A	N/A	N/A	N/A	N/A	N/A				
WASHING	YT-2101-RM1-HHW-FD	5	Classroom #1 high hand washing faucet	non-detect	No	N/A	N/A	N/A	N/A	N/A	N/A	N/A				
WASHING	YT-2101-BATHBOY-HHWA-FD	6	Boys' restroom high hand washing faucet A with motion sensor	non-detect	No	N/A	N/A	N/A	N/A	N/A	N/A	N/A				
WASHING	YT-2101-BATHBOY-HHWB-FD	7	Boys' restroom high hand washing faucet B with motion sensor	non-detect	No	N/A	N/A	N/A	N/A	N/A	N/A	N/A				
WASHING	YT-2101-BATHBOY-HHWC-FD	8	Boys' restroom high hand washing faucet C with motion sensor	non-detect	No	N/A	N/A	N/A	N/A	N/A	N/A	N/A				
WASHING	YT-2101-BATHBOY-HHWD-FD	9	Boys' restroom high hand washing faucet D with motion sensor	non-detect	No	N/A	N/A	N/A	N/A	N/A	N/A	N/A				
WASHING	YT-2101-BATHBOY-HHWE-FD	10	Boys' restroom high hand washing faucet E with motion sensor	non-detect	No	N/A	N/A	N/A	N/A	N/A	N/A	N/A				
WASHING	YT-2101-BATHGIRL-HHWA-FD	14	Girls' restroom high hand washing faucet A with motion sensor	non-detect	No	N/A	N/A	N/A	N/A	N/A	N/A	N/A				
WASHING	YT-2101-BATHGIRL-HHWB-FD	15	Girls' restroom high hand washing faucet B with motion sensor	non-detect	No	N/A	N/A	N/A	N/A	N/A	N/A	N/A				
WASHING	YT-2101-BATHGIRL-HHWC-FD	16	Girls' restroom high hand washing faucet C with motion sensor	non-detect	No	N/A	N/A	N/A	N/A	N/A	N/A	N/A				
WASHING	YT-2101-BATHGIRL-HHWD-FD	17	Girls' restroom high hand washing faucet D with motion sensor	non-detect	No	N/A	N/A	N/A	N/A	N/A	N/A	N/A				
WASHING	YT-2101-BATHGIRL-HHWE-FD	18	Girls' restroom high hand washing faucet E	1	No	N/A	N/A	N/A	N/A	N/A	N/A	10/18/2024: Not sampled. Awaiting repairs. 1/24/2025: Outlet sampled				
WASHING	YT-2101-RM4-HHW-FD	21	Classroom #4 high hand washing faucet	3	No	N/A	N/A	N/A	N/A	N/A	N/A	N/A				
WASHING	YT-2101-RM3-HHW-FD	22	Classroom #3 high hand washing faucet	non-detect	No	N/A	N/A	N/A	N/A	N/A	N/A	N/A				
WASHING	YT-2101-RM2-HHW-FD	23	Classroom #2 high hand washing faucet	non-detect	No	N/A	N/A	N/A	N/A	N/A	N/A	N/A				

Table 2. Summary Statistics

CATEGORY	INITIAL SAMPLING RESULTS		RE-SAMPLING RESULTS			POST REMEDIATION RESULTS
			Recommended Level = 10 parts per billion (ppb)			
	First Draw		Water Fountain Follow up Flush Sample - Collected day before First Draw Sampling	First Draw	Follow up Flush - Collected 30 seconds after First Draw Sampling	First Draw
Total Drinking	4	0	0	0	0	0
Total Drinking > 10 ppb	0	0	0	0	0	0
Total Cooking	1	0	0	0	0	0
Total Cooking > 10 ppb	0	0	0	0	0	0
Total Washing	16	0	0	0	0	0
Total Washing > 10 ppb	0	0	0	0	0	0
Total Samples	21	0	0	0	0	0
Total Samples > 10 ppb	0	0	0	0	0	0

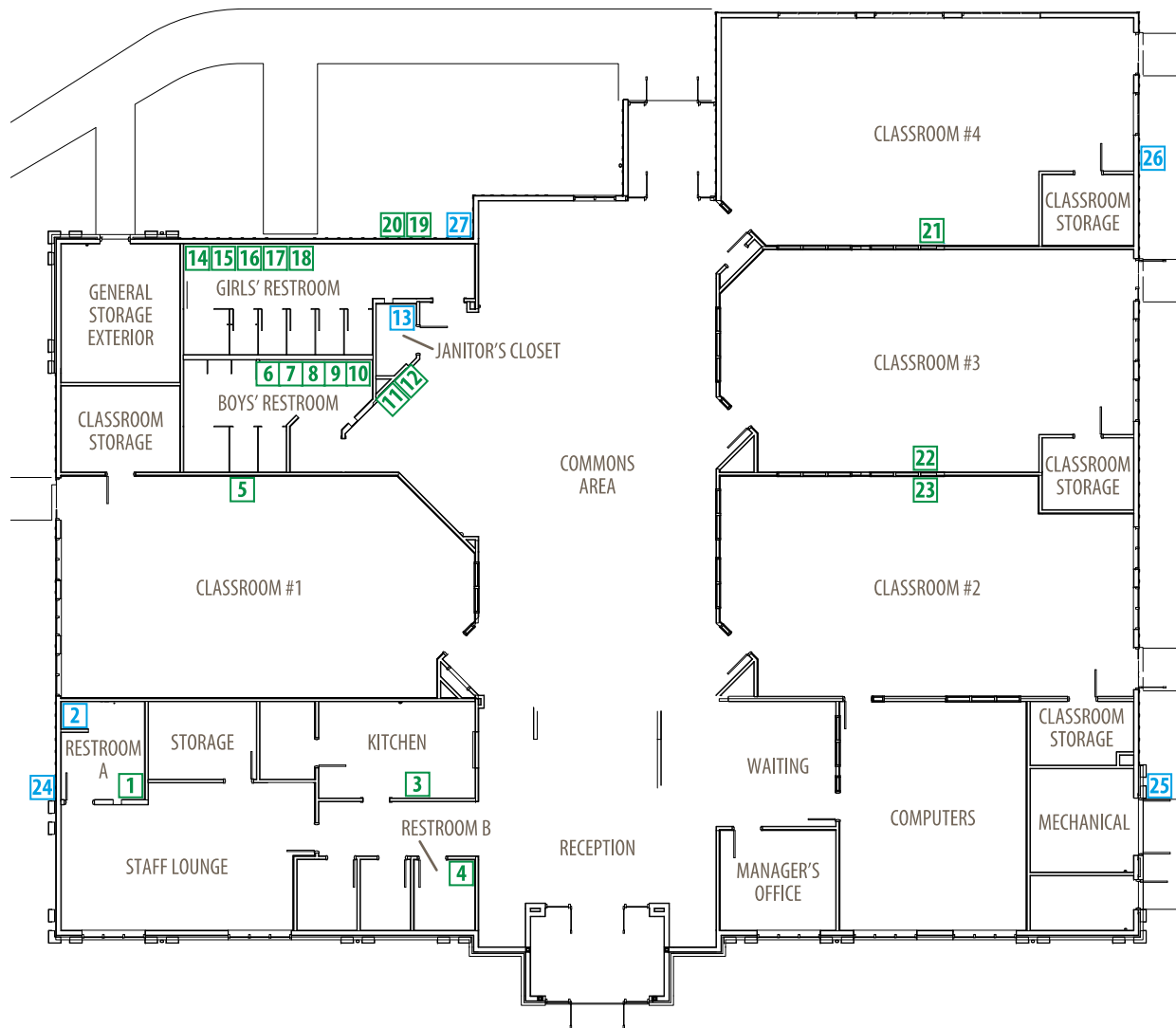

#### LEGEND

00 Outlet

00 Sample results below 10 parts per billion



**Figure 1.**  
**Building 2101 – Floor Plan**  
 NWS Yorktown  
 Yorktown, Virginia

**ch2m.**

Outlet No.	Type of Fixture	Location Description	Exceeded?
1	High hand washing faucet with motion sensor	Restroom A	No
2	Shower head	Restroom A	Not sampled; not used for drinking
3	Kitchen sink for dishwashing and food preparation	Kitchen	No
4	High hand washing faucet with motion sensor	Restroom B	No
5	High hand washing faucet	Classroom #1	No
6	High hand washing faucet with motion sensor	Boys' Restroom	No
7	High hand washing faucet with motion sensor	Boys' Restroom	No
8	High hand washing faucet with motion sensor	Boys' Restroom	No
9	High hand washing faucet with motion sensor	Boys' Restroom	No
10	High hand washing faucet with motion sensor	Boys' Restroom	No
11	Water fountain (cooler)	Hallway	No
12	Water fountain (cooler)	Hallway	No
13	Utility sink	Janitor's Closet	Not sampled; not used for drinking
14	High hand washing faucet with motion sensor	Girls' Restroom	No
15	High hand washing faucet with motion sensor	Girls' Restroom	No
16	High hand washing faucet with motion sensor	Girls' Restroom	No
17	High hand washing faucet with motion sensor	Girls' Restroom	No
18	High hand washing faucet	Girls' Restroom	No
19	Water fountain (bubbler)	Outside of Building 2101	No
20	Water fountain (bubbler)	Outside of Building 2101	No
21	High hand washing faucet	Classroom #4	No
22	High hand washing faucet	Classroom #3	No
23	High hand washing faucet	Classroom #2	No
24	Hose bib	Outside of Building 2101	Not sampled; not used for drinking
25	Hose bib	Outside of Building 2101	Not sampled; not used for drinking
26	Hose bib	Outside of Building 2101	Not sampled; not used for drinking
27	Hose bib	Outside of Building 2101	Not sampled; not used for drinking